

Topic: Treadmill Walk Belt Lubrication and the Lubrication Prompt

Date: 2009-03-10

Overview: In late 2008, SportsArt added a prompt to remind people to lubricate treadmill walk belts. This document explains what to do when the lubrication prompt appears. It also explains walk belt lubrication as part of a treadmill maintenance program.

Applies to treadmills with the lubrication prompt: T610, T620, T625, T630, T650, T650M, T670, and T680

Lubrication Prompt

When total distance exceeds 4000 KM/2500 miles and the walk belt stops moving, the message “SERVICE NEEDED- APPLY LUBE” appears on the treadmill display.

Until total distance exceeds 4100 KM/2560 miles, the treadmill can be operated normally. At over 4100 KM/2560 miles, the “SERVICE NEEDED- APPLY LUBE” message will remain on the screen and the treadmill will not operate until the following process is completed.

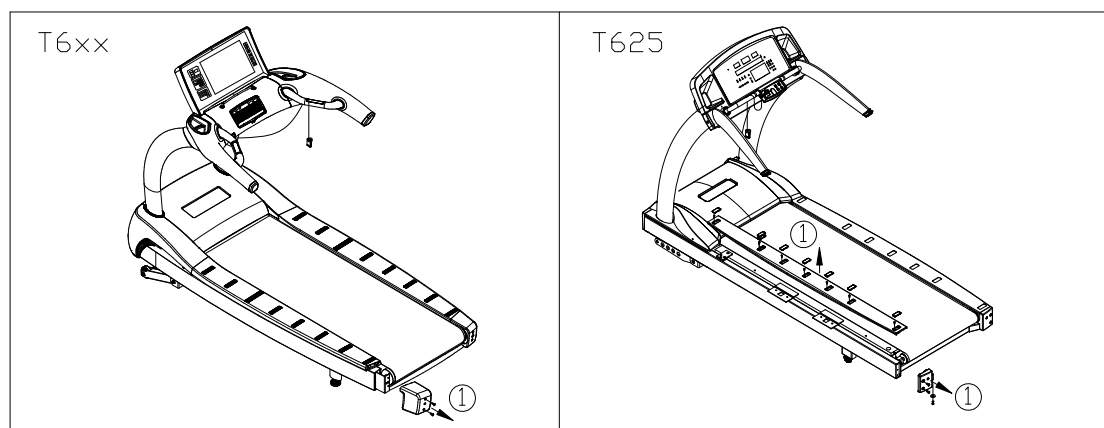

1. On T630, T650, T650M, T670, T680 treadmills, remove one end cap (left). On T610, T620, T625 treadmills, remove one end cap and one landing strip (right).

2. Simultaneously press and hold INCLINE ▲ + INCLINE ▼ + 0 keys for two seconds. This activates the “lubrication mode.” The treadmill will operate at the lowest speed. At this point, ▲ and ▼ command keys will not operate.

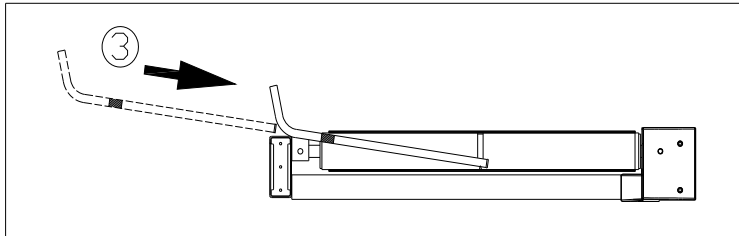

3. Insert the lubrication applicator tube so the line on the applicator tube touches the edge of the walk belt.

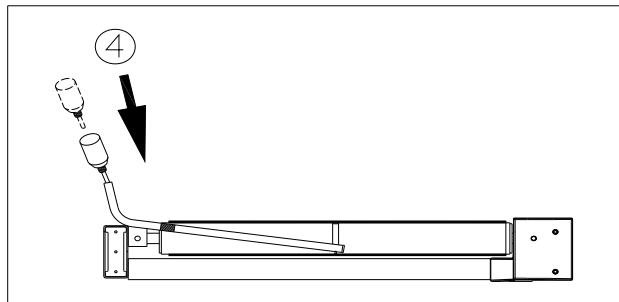

4. Squeeze 50cc of HyperGlide™ lubricant out of the bottle and into the applicator tube.

5. Hold the applicator tube in place for about two minutes while the walk belt rotates slowly.

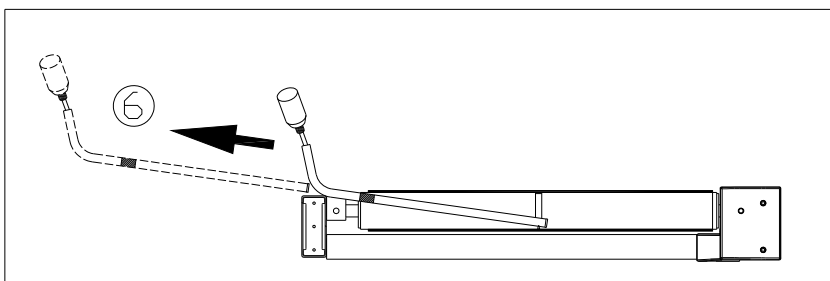

6. Remove the bottle of lubricant and the applicator tube. The message “PLEASE PRESS THE STOP KEY AFTER FINISHING LUBRICATION” appears. Press the STOP key to stop the walk belt and exit the lubrication mode.

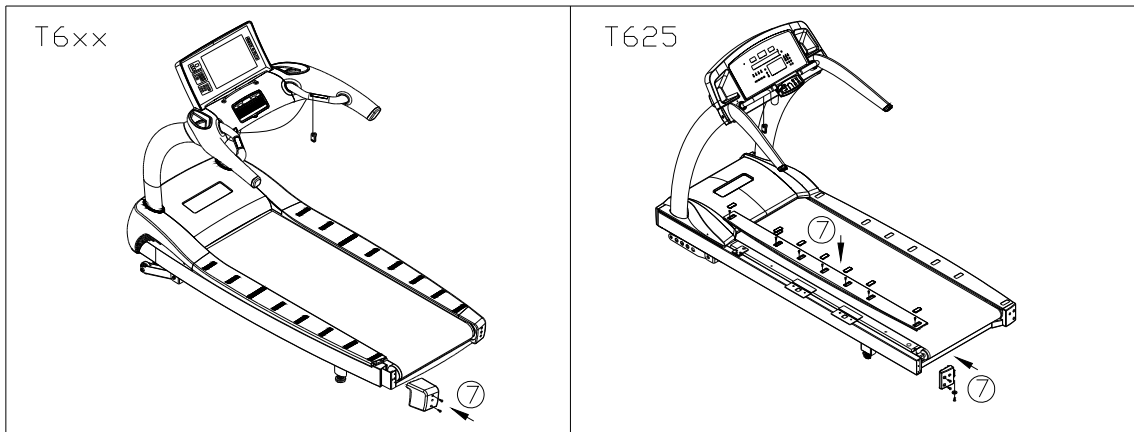

7. Secure the end cap on T630, T650, T650M, T670, T680 treadmills. On T610, T620, T625 treadmills, secure the landing strip and the end cap. This completes the lubrication procedure.

Lubricating When Not Prompted

The lubrication mode can be activated at any time through the following procedure:

1. Turn on the treadmill power switch.
2. The startup banner will appear. Example: "SPORTSART-T650" scrolls across the screen.
3. While the startup banner appears, simultaneously press and hold INCLINE ▲ + INCLINE ▼ + 0 keys for two seconds.

The walk belt will operate at the lowest speed. Follow instructions above to apply HyperGlide™ lubricant. When the message "PLEASE PRESS THE STOP KEY AFTER FINISHING LUBRICATION" appears, press the STOP key. Complete the lubrication process as explained above.

Lubrication Policy

SportsArt recommends lubricating treadmill walk belts every 4000 KM or 2500 miles, or whenever the bottom side of the walk belt feels dry.

Lubrication Materials

SportsArt light commercial and full commercial treadmills, including T610, T620, T625, T630, T650, T650M, T670, and T680, are shipped with bottles of HyperGlide™ lubricant. Other lubrication materials are available for purchase.

SportsArt Walk Belt Lubrication Kit

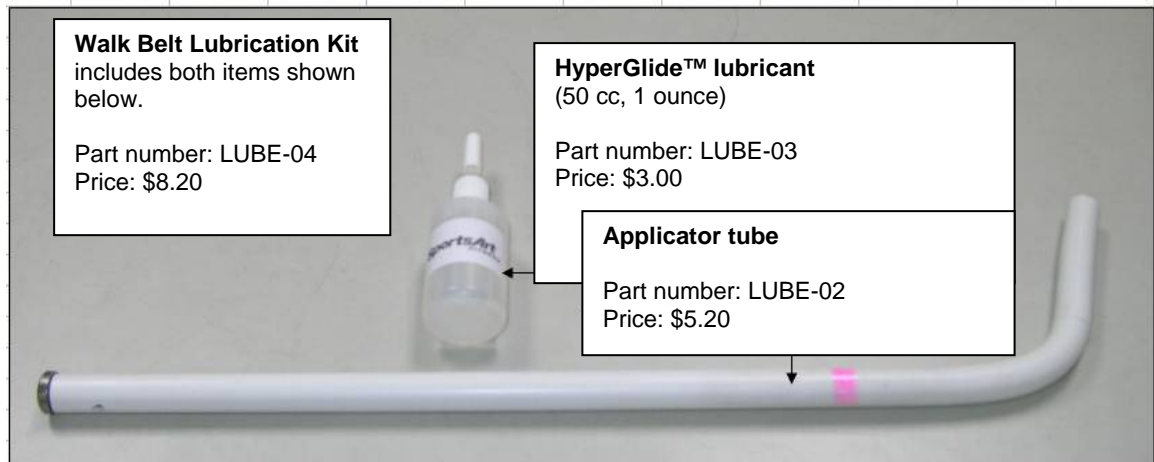

Order these parts online at www.SportsArtAmerica.com or by calling the SportsArt service department at 1-866-709-1750.

Periodic Maintenance Tips

In addition to walk belt lubrication, periodic maintenance should be performed regularly by a qualified service technician.* We recommend that the following tasks be undertaken at least every 4000 KM or 2500 miles, or every six months, whichever comes first.

1. Ensure proper power supply. Inspect the power supply, power cord, on/off switch, etc.
2. Is the treadmill level? Adjust levelers if necessary.
3. Vacuum under the motor cover.
4. Secure all cable connections.
5. Inspect drive belt tightness. Adjust if necessary. Inspect drive belt for wear. Replace it if necessary.
6. Inspect walk belt tightness. Adjust if necessary. Inspect walk belt for wear. Replace it if necessary.
7. Wipe the deck clean with a clean, damp cloth. Inspect the deck for wear.
8. Lubricate the deck and walk belt.
9. Wipe entire unit with a clean, damp cloth.
10. Test unit operation. Replace parts if necessary.

* For safety, always disconnect the power source before removing unit covers. Some components retain an electrical charge after power is disconnected. Keep hands and clothing away from moving parts. **END**